

⚠ WARNING

CALIFORNIA Proposition 65 Warning

This product contains a chemical or chemicals known to the State of California to cause cancer, birth defects, or reproductive harm.

Safety

Installing this kit will change the weight of your plow. Ensure that your vehicle does not exceed the gross-vehicle-weight rating (GVWR) at any time. You may need to weigh the vehicle and add ballast or limit the payload of the vehicle to compensate.

Installation

1. If the plow is mounted to a vehicle, park the machine on a level surface, shut off the engine, wait for all moving parts to stop, engage the parking brake, and remove the key.
2. Remove and retain the plow blade guides.
3. On each side of the plow blade, position the rib plate as shown in [Figure 1](#).

Important: Ensure that the bottom of the rib plate is 9.5 mm (3/8 inch) from the bottom of the plow rib.

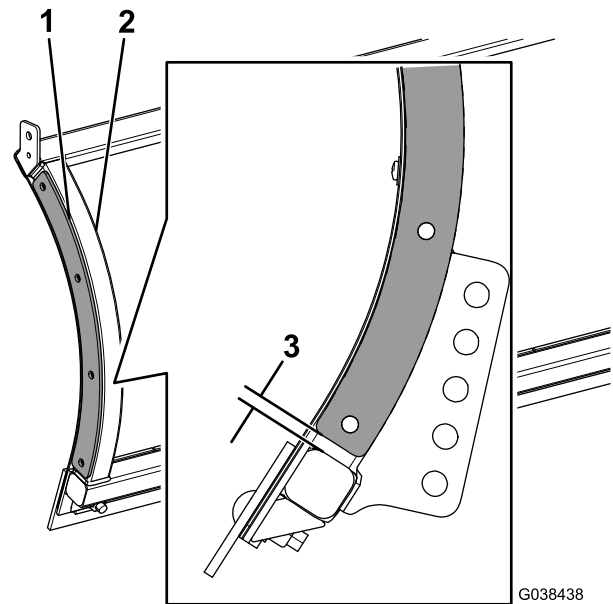
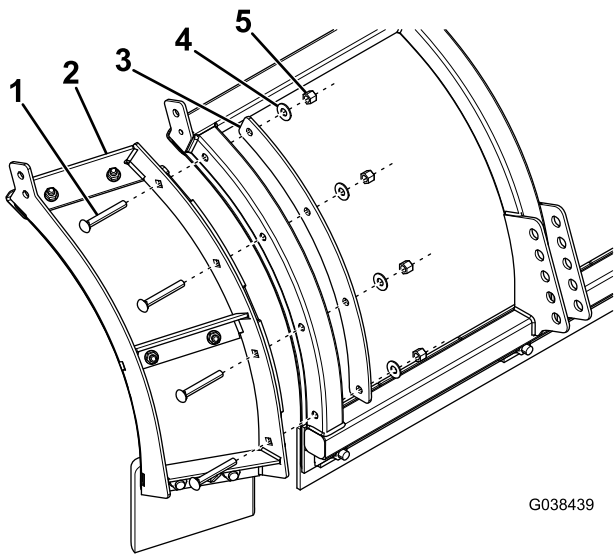

Figure 1

1. Rib plate
2. Plow rib
3. 9.5 mm (3/8 inch) gap

4. Clamp the rib plates in place and mark the hole positions on the plow rib.
5. Remove the rib plates and drill holes (7/16 inch) at each of the marks.
6. Secure each blade extension and rib plate to the plow rib using 4 carriage bolts, 4 flat washers, and 4 locknuts (3/8 inch) as shown in [Figure 2](#).

Note: Torque the bolts to 31 N·m (23 ft-lb).



G038439

Figure 2

- | | |
|--------------------|----------------|
| 1. Carriage bolt | 4. Flat washer |
| 2. Blade extension | 5. Locknut |
| 3. Rib plate | |

7. Install the previously removed plow blade guides using the existing top bolt and nut, and a new 5/16-inch bolt and locknut ([Figure 3](#)).

Note: Torque the bolts to 19 N·m (14 ft-lb).

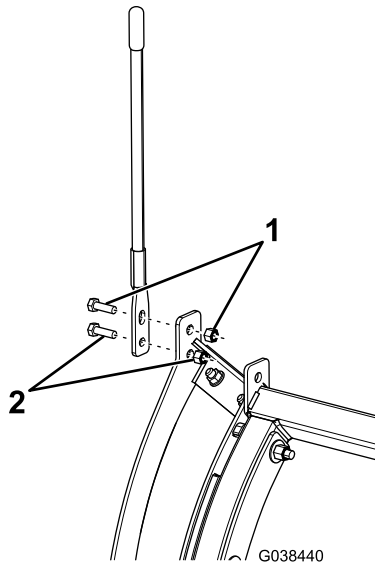

G038440

Figure 3

- | | |
|----------------------|-----------------------------------|
| 1. Existing hardware | 2. New 5/16-inch bolt and locknut |
|----------------------|-----------------------------------|